

Courses & distances down the
Allegany River from the Head

- S 67 W 61 ✓
- S 63 W 38 ✓
- S 72 W 32 ✓
- S 60 W 46 ✓
- S 50 W 30 ✓
- S 68 W 26 ✓
- S 54 W 48 ✓
- S 48 W 68 ✓
- S 16 W 48 ✓
- S 5 E 41 ✓
- S 31 E 50 ✓
- S 44 E 90 ✓
- S 77 E 34 ✓
- S 82 E 78 ✓
- East 16 ✓
- N 62 E 26 ✓
- N 39 E 37 ✓
- N 23 E 198 ✓
- N 43 E 62 ✓
- N 70 E 68 ✓
- N 61 E 64 ✓
- N 79 E 45 ✓
- S 68 E 10 ✓
- East 23 ✓
- N 84 E 40 ✓
- S 71 E 114 Hick. ✓
- S 47 E 38 ✓
- S 12 E 40 ✓
- S 23 E 25 ✓
- S 7 W 80 ✓
- S 6 E 74 ✓
- S 4 W 70 ✓
- S 18 W 85 ✓
- S 11 W 20 Post 1745

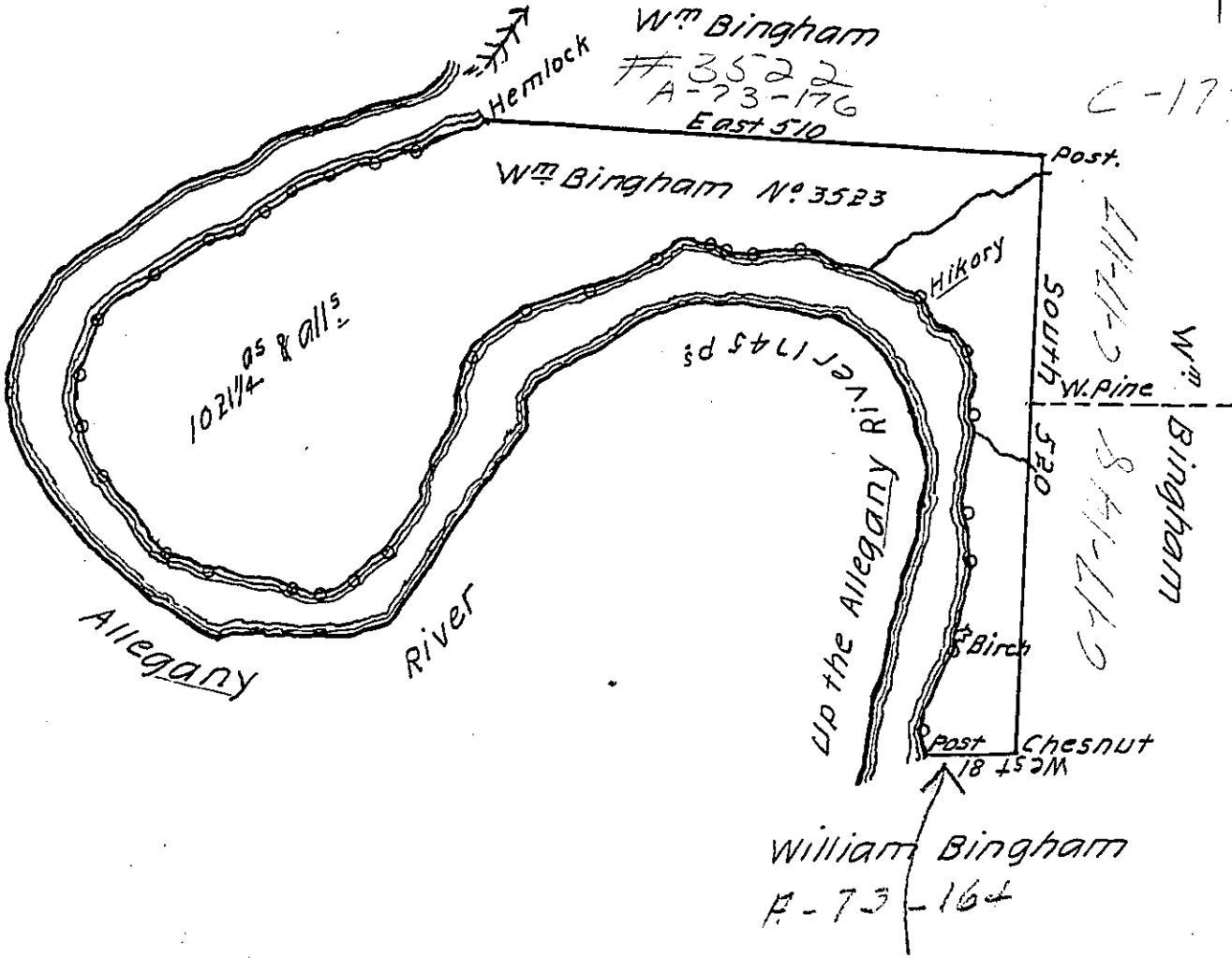

In pursuance of a Warrant, No 3523 dated the 14th day of Dec. 1792 surveyed 4th Aug^t. 1794 To William Bingham the above described tract of Land situate on the Allegany River in the late purchase Northumberland County ^{Dist^t No 6} containing one thousand and twenty one & an half, Acres, and the Allowance of six P^c Cent.

P In^o Brodhead DS

Daniel Brodhead Esq^r
Surveyor General

IN TESTIMONY that the above is a copy of the original remaining on file in the Department of Internal Affairs of Pennsylvania, made conformably to an Act of Assembly approved the 16th day of February, 1833, I have hereunto set my Hand and caused the Seal of said Department to be affixed at Harrisburg, this twenty-fifth day of May, 1911.

Henry Houck
Secretary of Internal Affairs.